



3. Reduzierungen

Reducers

Seite
page

- | | | |
|-----|---------------------------------------------------------------------|----|
| 3.1 | STERI-Red® K DIN 11865-RK
concentric reducer for orbital welding | 81 |
| 3.2 | STERI-Red® E DIN 11865-RE
eccentric reducer for orbital welding | 85 |
| 3.3 | Red-Stück K
concentric reducer, short type | 89 |
| 3.4 | Red-Stück E
eccentric reducer, short type | 92 |



3.1 STERI-Red® K DIN 11865-RK

konzentrische Reduzierung mit Orbitalschweißenden

concentric reducer for orbital welding

Legende

A / A1 Außendurchmesser
B / B1 Innendurchmesser
C Gesamtlänge

Abmessungen

DIN 11866-A (DIN 11850)
DIN 11866-B (EN ISO 1127)
DIN 11866-C (ASME BPE)

Normative Verweisungen, Anforderungen / Abnahmen (Vormaterial)

DIN 11865
BN2
EN 10088-1/-3
EN 10204
EN 10272
ASTM A276
ASTM A182/A182M / ASME SA182/SA182M
ASTM A479/A479M / ASME SA479/SA479M
AD 2000-W2

Kennzeichnung

Hersteller, Werkstoff, Abmessung, Schmelze,
DIN 11865

Toleranzen (Bezugsnorm)

DIN 11865 / ISO 2768-1

Verpackung

Schweißenden mit Kunststoffkappen verschlossen,
einzeln verpackt.

Werkstoffe

1.4435

weitere Werkstoffe auf Anfrage

Oberflächenbeschaffenheit ("MB")

innen: feinstgedreht, Ra < 0.8 µm
außen: feingedreht, Ra < 1.6 µm

Key

external diameter
internal diameter
total length

Dimensions

DIN 11866-A (DIN 11850)
DIN 11866-B (EN ISO 1127)
DIN 11866-C (ASME BPE)

Normative References, Requirements / Approvals (raw material)

DIN 11865
BN2
EN 10088-1/-3
EN 10204
EN 10272
ASTM A276
ASTM A182/A182M / ASME SA182/SA182M
ASTM A479/A479M / ASME SA479/SA479M
AD 2000-W2

Marking

manufacturer, material, dimension, heat,
DIN 11865

Tolerances (reference standard)

DIN 11865 / ISO 2768-1

Packaging

Welding ends covered with plastic caps,
wrapped separately.

Materials

316L

further materials on request

Surface condition ("MB")

inside: ultra-fine turned, Ra < 0.8 µm
outside: refined turned, Ra < 1.6 µm



Oberflächenqualitäten | surface qualities

Innenoberfläche internal surface finish	(Zusatz-) Artikel-Nr. (additional) order No
Ra < 0.6 µm (STERI-line®)	999279
Ra < 0.5 µm (STERI-line®)	999280
Ra < 0.4 µm (HQ-line®)	999281
Ra < 0.25 µm (HQ-line®)	999283

Bestellbeispiel | ordering example

Artikelbezeichnung + Ausführungen article description + variants	Artikel-Nr. order No
STERI-Red® K DN025/015 DIN (1.4435) concentric reducer DIN 11865-RK	707215
e-polier e-polished	
Ra < 0.6 µm	+ 999279

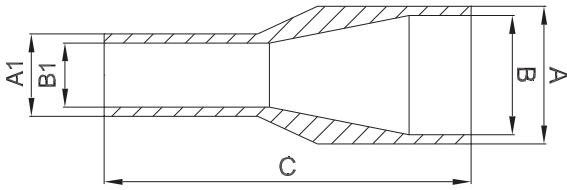

weitere Abmessungen auf Anfrage | further dimensions on request

DIN	A	B	A1	B1	C	MB 1.4435	e-pol. 1.4435		
DN008/DN004*	10.0	8.0	6.0	4.0	38.0	703785	710663		
DN008/DN006	10.0	8.0	8.0	6.0	38.0	703784	710664		
DN010/DN004*	12.0	10.0	6.0	4.0	38.0	702677	710665		
DN010/DN004*	13.0	10.0	6.0	4.0	38.0	707831	710666		
DN010/DN006*	12.0	10.0	8.0	6.0	38.0	702680	710667		
DN010/DN006	13.0	10.0	8.0	6.0	38.0	707266	710668		
DN010/DN008*	12.0	10.0	10.0	8.0	38.0	702678	709155		
DN010/DN008	13.0	10.0	10.0	8.0	38.0	705708	710669		
DN015/DN004*	19.0	16.0	6.0	4.0	60.0	706271	710670		
DN015/DN006*	19.0	16.0	8.0	6.0	60.0	703085	710671		
DN015/DN008	19.0	16.0	10.0	8.0	60.0	702681	709807		
DN015/DN010*	19.0	16.0	12.0	10.0	60.0	702000	708008		
DN015/DN010	19.0	16.0	13.0	10.0	60.0	703892	704207		
DN020/DN006*	23.0	20.0	8.0	6.0	60.0	705075	710672		
DN020/DN008*	23.0	20.0	10.0	8.0	60.0	706043	710673		
DN020/DN010*	23.0	20.0	12.0	10.0	60.0	702001	708496		
DN020/DN010	23.0	20.0	13.0	10.0	60.0	703891	708497		
DN020/DN015	23.0	20.0	19.0	16.0	60.0	702002	709261		
DN025/DN010*	29.0	26.0	12.0	10.0	70.0	702003	706469		
DN025/DN010*	29.0	26.0	13.0	10.0	70.0	703890	708907		
DN025/DN015	29.0	26.0	19.0	16.0	70.0	702004	707215		
DN025/DN020	29.0	26.0	23.0	20.0	70.0	702005	707263		
DN032/DN010*	35.0	32.0	12.0	10.0	80.0	702006	710674		
DN032/DN010*	35.0	32.0	13.0	10.0	80.0	705709	710675		
DN032/DN015*	35.0	32.0	19.0	16.0	80.0	702007	708203		
DN032/DN020	35.0	32.0	23.0	20.0	80.0	702008	710676		
DN032/DN025	35.0	32.0	29.0	26.0	80.0	702009	707550		
DN040/DN010*	41.0	38.0	12.0	10.0	90.0	703458	708516		
DN040/DN010*	41.0	38.0	13.0	10.0	90.0	704127	710677		
DN040/DN015*	41.0	38.0	19.0	16.0	90.0	702010	709262		
DN040/DN020	41.0	38.0	23.0	20.0	90.0	702011	708896		
DN040/DN025	41.0	38.0	29.0	26.0	90.0	702012	708204		
DN040/DN032	41.0	38.0	35.0	32.0	90.0	702013	708014		
DN050/DN010*	53.0	50.0	12.0	10.0	90.0	705710	710678		
DN050/DN010*	53.0	50.0	13.0	10.0	90.0	702617	710679		
DN050/DN015*	53.0	50.0	19.0	16.0	90.0	702014	710680		
DN050/DN020*	53.0	50.0	23.0	20.0	90.0	702015	709764		
DN050/DN025	53.0	50.0	29.0	26.0	90.0	702016	707207		
DN050/DN032	53.0	50.0	35.0	32.0	90.0	702017	707208		
DN050/DN040	53.0	50.0	41.0	38.0	90.0	702018	708517		
DN065/DN015*	70.0	66.0	19.0	16.0	110.0	704371	710681		
DN065/DN020*	70.0	66.0	23.0	20.0	110.0	702019	710682		



3.1 STERI-Red® K DIN 11865-RK

zusätzliche Oberflächenqualitäten analog Seite | additional surface qualities analog page 81

DIN	A	B	A1	B1	C	MB 1.4435	e-pol. 1.4435		
DN065/DN025*	70.0	66.0	29.0	26.0	110.0	702020	710683		
DN065/DN032*	70.0	66.0	35.0	32.0	110.0	702021	710684		
DN065/DN040	70.0	66.0	41.0	38.0	110.0	702022	710685		
DN065/DN050	70.0	66.0	53.0	50.0	110.0	702023	709510		
DN080/DN015*	85.0	81.0	19.0	16.0	110.0	703084	710686		
DN080/DN020*	85.0	81.0	23.0	20.0	110.0	705711	710687		
DN080/DN025*	85.0	81.0	29.0	26.0	110.0	703563	710688		
DN080/DN032*	85.0	81.0	35.0	32.0	110.0	702024	710689		
DN080/DN040*	85.0	81.0	41.0	38.0	110.0	702025	708298		
DN080/DN050	85.0	81.0	53.0	50.0	110.0	702026	710690		
DN080/DN065	85.0	81.0	70.0	66.0	110.0	702027	710691		
DN100/DN015*	104.0	100.0	19.0	16.0	135.0	704608	710692		
DN100/DN020*	104.0	100.0	23.0	20.0	135.0	702028	710693		
DN100/DN025*	104.0	100.0	29.0	26.0	135.0	702029	710694		
DN100/DN032*	104.0	100.0	35.0	32.0	135.0	702030	710695		
DN100/DN040*	104.0	100.0	41.0	38.0	135.0	702031	710696		
DN100/DN050*	104.0	100.0	53.0	50.0	135.0	702069	710697		
DN100/DN065	104.0	100.0	70.0	66.0	135.0	702034	710698		
DN100/DN080	104.0	100.0	85.0	81.0	135.0	702033	710699		
DN125/DN080	129.0	125.0	85.0	81.0	150.0	710700	710704		
DN125/DN100	129.0	125.0	104.0	100.0	150.0	705480	710705		
DN150/DN100	154.0	150.0	104.0	100.0	170.0	706457	710706		
DN150/DN125	154.0	150.0	129.0	125.0	170.0	710701	710707		
DN200/DN125	204.0	200.0	129.0	125.0	230.0	710702	710708		
DN200/DN150	204.0	200.0	154.0	150.0	230.0	710703	710709		

*) nicht in der DIN-Norm enthalten | non-standard

ISO	A	B	A1	B1	C	MB 1.4435	e-pol. 1.4435		
DN010/DN008	17.2	14.0	13.5	10.3	60.0	701859	707696		
DN015/DN008	21.3	18.1	13.5	10.3	60.0	701819	707697		
DN015/DN010	21.3	18.1	17.2	14.0	60.0	701818	707698		
DN020/DN008*	26.9	23.7	13.5	10.3	60.0	701820	707699		
DN020/DN010	26.9	23.7	17.2	14.0	60.0	701821	707700		
DN020/DN015	26.9	23.7	21.3	18.1	60.0	701822	707262		
DN025/DN008*	33.7	29.7	13.5	10.3	70.0	701823	707701		
DN025/DN010*	33.7	29.7	17.2	14.0	70.0	703855	707702		
DN025/DN015	33.7	29.7	21.3	18.1	70.0	701825	707703		
DN025/DN020	33.7	29.7	26.9	23.7	70.0	701826	707704		
DN032/DN008*	42.4	38.4	13.5	10.3	80.0	701902	707705		
DN032/DN010*	42.4	38.4	17.2	14.0	80.0	701828	707706		
DN032/DN015*	42.4	38.4	21.3	18.1	80.0	701829	707707		
DN032/DN020	42.4	38.4	26.9	23.7	80.0	701903	707708		
DN032/DN025	42.4	38.4	33.7	29.7	80.0	701831	707709		
DN040/DN008*	48.3	44.3	13.5	10.3	90.0	705042	707710		
DN040/DN010*	48.3	44.3	17.2	14.0	90.0	701905	707711		
DN040/DN015*	48.3	44.3	21.3	18.1	90.0	701833	707712		
DN040/DN020	48.3	44.3	26.9	23.7	90.0	701906	707713		
DN040/DN025	48.3	44.3	33.7	29.7	90.0	701835	707714		
DN040/DN032	48.3	44.3	42.4	38.4	90.0	701836	707715		
DN050/DN015*	60.3	56.3	21.3	18.1	100.0	701837	707717		
DN050/DN020*	60.3	56.3	26.9	23.7	100.0	701838	707718		
DN050/DN025	60.3	56.3	33.7	29.7	100.0	701839	707719		
DN050/DN032	60.3	56.3	42.4	38.4	100.0	701840	707720		
DN050/DN040	60.3	56.3	48.3	44.3	100.0	701841	707721		
DN065/DN015*	76.1	72.1	21.3	18.1	110.0	701842	707722		
DN065/DN020*	76.1	72.1	26.9	23.7	110.0	701843	707723		



ISO	A	B	A1	B1	C	MB 1.4435	e-pol. 1.4435		
DN065/DN025*	76.1	72.1	33.7	29.7	110.0	701844	707724		
DN065/DN032*	76.1	72.1	42.4	38.4	110.0	701845	707725		
DN065/DN040	76.1	72.1	48.3	44.3	110.0	701846	707726		
DN065/DN050	76.1	72.1	60.3	56.3	110.0	701847	707727		
DN080/DN015*	88.9	84.3	21.3	18.1	110.0	704794	707728		
DN080/DN020*	88.9	84.3	26.9	23.7	110.0	705712	707729		
DN080/DN025*	88.9	84.3	33.7	29.7	110.0	701848	707730		
DN080/DN032*	88.9	84.3	42.4	38.4	110.0	701849	707731		
DN080/DN040*	88.9	84.3	48.3	44.3	110.0	701850	707732		
DN080/DN050	88.9	84.3	60.3	56.3	110.0	704126	707733		
DN080/DN065	88.9	84.3	76.1	72.1	110.0	701851	707734		
DN100/DN025*	114.3	109.7	33.7	29.7	135.0	701853	707735		
DN100/DN032*	114.3	109.7	42.4	38.4	135.0	701854	707736		
DN100/DN040*	114.3	109.7	48.3	44.3	135.0	701855	707737		
DN100/DN050*	114.3	109.7	60.3	56.3	135.0	701856	707738		
DN100/DN065	114.3	109.7	76.1	72.1	135.0	701857	707739		
DN100/DN080	114.3	109.7	88.9	84.3	135.0	701858	707740		
DN125/DN080	139.7	134.5	88.9	84.3	150.0	702690	710712		
DN125/DN100	139.7	134.5	114.3	109.7	150.0	703807	710713		
DN150/DN100	168.3	163.1	114.3	109.7	170.0	703835	710714		
DN150/DN125	168.3	163.1	139.7	134.5	170.0	703801	710715		
DN200/DN125	219.1	213.9	139.7	134.5	230.0	710710	710716		
DN200/DN150	219.1	213.9	168.3	163.1	230.0	710711	710717		

ASME BPE	A	B	A1	B1	C	MB 1.4435	e-pol. 1.4435		
DN 3/8"/DN 1/4"	9.53	7.75	6.35	4.57	38.0	710719	710723		
DN 1/2"/DN 1/4"	12.7	9.4	6.35	4.57	38.0	710720	710724		
DN 1/2"/DN 3/8"	12.7	9.4	9.53	7.75	38.0	710721	710725		
DN 3/4"/DN 3/8"	19.05	15.75	9.53	7.75	60.0	705640	710726		
DN 3/4"/DN 1/2"	19.05	15.75	12.7	9.4	60.0	702638	710727		
DN 1"/DN 3/8"*	25.4	22.1	9.53	7.75	60.0	705639	710728		
DN 1"/DN 1/2"	25.4	22.1	12.7	9.4	60.0	702640	710729		
DN 1"/DN 3/4"	25.4	22.1	19.05	15.75	60.0	702639	710730		
DN 1 1/2"/DN 1/2"*	38.1	34.8	12.7	9.4	80.0	705642	710731		
DN 1 1/2"/DN 3/4"	38.1	34.8	19.05	15.75	80.0	702642	710732		
DN 1 1/2"/DN 1"	38.1	34.8	25.4	22.1	80.0	702641	709338		
DN 2"/DN 3/4"*	50.8	47.5	19.05	15.75	90.0	702645	710733		
DN 2"/DN 1"	50.8	47.5	25.4	22.1	90.0	702644	710734		
DN 2"/DN 1 1/2"	50.8	47.5	38.1	34.8	90.0	702643	710735		
DN 2 1/2"/DN 1"	63.5	60.2	25.4	22.1	100.0	702648	710736		
DN 2 1/2"/DN 1 1/2"	63.5	60.2	38.1	34.8	100.0	702647	710737		
DN 2 1/2"/DN 2"	63.5	60.2	50.8	47.5	100.0	702646	710738		
DN 3"/DN 1"*	76.2	72.9	25.4	22.1	110.0	702652	710739		
DN 3"/DN 1 1/2"	76.2	72.9	38.1	34.8	110.0	702651	710740		
DN 3"/DN 2"	76.2	72.9	50.8	47.5	110.0	702650	710741		
DN 3"/DN 2 1/2"	76.2	72.9	63.5	60.2	110.0	702649	710742		
DN 4"/DN 2"	101.6	97.38	50.8	34.8	135.0	702655	710743		
DN 4"/DN 2 1/2"	101.6	97.38	63.5	47.5	135.0	702654	710744		
DN 4"/DN 3"	101.6	97.38	76.2	72.9	135.0	702653	710745		
DN 6"/DN 4"	152.4	146.86	101.6	97.38	170.0	710722	710746		

*) nicht in der DIN-Norm enthalten | non-standard

Sonder-Reduzierungen (wie z.B. DIN/ISO, ASME BPE/DIN, etc.)
sind ebenfalls (teilweise aus Vorrat) lieferbar.Special reducers (e.g. DIN/ISO, ASME BPE/DIN, etc.)
are also consignable (partially from stock).



3.2 STERI-Red® E DIN 11865-RE

exzentrische Reduzierung mit Orbitalschweißenden

eccentric reducer for orbital welding

Legende

- A / A1 Außendurchmesser
- B / B1 Innendurchmesser
- C Gesamtlänge

Abmessungen

- DIN 11866-A (DIN 11850)
- DIN 11866-B (EN ISO 1127)
- DIN 11866-C (ASME BPE)

Normative Verweisungen, Anforderungen / Abnahmen (Vormaterial)

- DIN 11865
- BN2
- EN 10088-1/-3
- EN 10204
- EN 10272
- ASTM A276
- ASTM A182/A182M / ASME SA182/SA182M
- ASTM A479/A479M / ASME SA479/SA479M
- AD 2000-W2

Kennzeichnung

Hersteller, Werkstoff, Abmessung, Schmelze,
DIN 11865

Toleranzen (Bezugsnorm)

DIN 11865 / ISO 2768-1

Verpackung

Schweißenden mit Kunststoffkappen verschlossen,
einzeln verpackt.

Werkstoffe

1.4435

weitere Werkstoffe auf Anfrage

Oberflächenbeschaffenheit ("MB")

innen: feinstgedreht, Ra < 0.8 µm
außen: feingedreht, Ra < 1.6 µm

Key

- external diameter
- internal diameter
- total length

Dimensions

- DIN 11866-A (DIN 11850)
- DIN 11866-B (EN ISO 1127)
- DIN 11866-C (ASME BPE)

Normative References, Requirements / Approvals (raw material)

- DIN 11865
- BN2
- EN 10088-1/-3
- EN 10204
- EN 10272
- ASTM A276
- ASTM A182/A182M / ASME SA182/SA182M
- ASTM A479/A479M / ASME SA479/SA479M
- AD 2000-W2

Marking

manufacturer, material, dimension, heat,
DIN 11865

Tolerances (reference standard)

DIN 11865 / ISO 2768-1

Packaging

Welding ends covered with plastic caps,
wrapped separately.

Materials

316L

further materials on request

Surface condition ("MB")

inside: ultra-fine turned, Ra < 0.8 µm
outside: refined turned, Ra < 1.6 µm



Oberflächenqualitäten | surface qualities

Innenoberfläche internal surface finish	(Zusatz-) Artikel-Nr. (additional) order No
Ra < 0.6 µm (STERI-line®)	999279
Ra < 0.5 µm (STERI-line®)	999280
Ra < 0.4 µm (HQ-line®)	999281
Ra < 0.25 µm (HQ-line®)	999283

Bestellbeispiel | ordering example

Artikelbezeichnung + Ausführungen article description + variants	Artikel-Nr. order No
STERI-Red® E DN025/015 DIN (1.4435) eccentric reducer DIN 11865-RE	708018
e-polier e-polished	
Ra < 0.6 µm	+ 999279

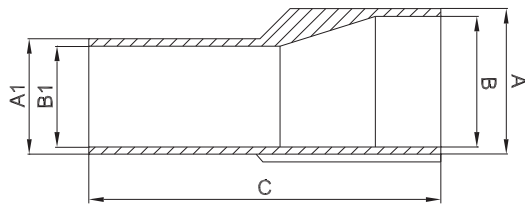

weitere Abmessungen auf Anfrage | further dimensions on request

DIN	A	B	A1	B1	C	MB 1.4435	e-pol. 1.4435		
DN008/DN004*	10.0	8.0	6.0	4.0	38.0	710748	710763		
DN008/DN006	10.0	8.0	8.0	6.0	38.0	705995	710764		
DN010/DN004*	12.0	10.0	6.0	4.0	38.0	710749	710765		
DN010/DN004*	13.0	10.0	6.0	4.0	38.0	710750	710766		
DN010/DN006*	12.0	10.0	8.0	6.0	38.0	703997	709584		
DN010/DN006	13.0	10.0	8.0	6.0	38.0	705641	710767		
DN010/DN008*	12.0	10.0	10.0	8.0	38.0	705996	708518		
DN010/DN008	13.0	10.0	10.0	8.0	38.0	705997	710768		
DN015/DN004*	19.0	16.0	6.0	4.0	60.0	706272	710769		
DN015/DN006*	19.0	16.0	8.0	6.0	60.0	710751	710770		
DN015/DN008	19.0	16.0	10.0	8.0	60.0	705998	710771		
DN015/DN010*	19.0	16.0	12.0	10.0	60.0	702041	707205		
DN015/DN010	19.0	16.0	13.0	10.0	60.0	703860	708006		
DN020/DN006*	23.0	20.0	8.0	6.0	60.0	710752	710772		
DN020/DN008*	23.0	20.0	10.0	8.0	60.0	710753	710773		
DN020/DN010*	23.0	20.0	12.0	10.0	60.0	702042	709154		
DN020/DN010	23.0	20.0	13.0	10.0	60.0	703862	709034		
DN020/DN015	23.0	20.0	19.0	16.0	60.0	702043	707206		
DN025/DN010*	29.0	26.0	12.0	10.0	70.0	702044	706468		
DN025/DN010*	29.0	26.0	13.0	10.0	70.0	703861	709298		
DN025/DN015	29.0	26.0	19.0	16.0	70.0	702045	708018		
DN025/DN020	29.0	26.0	23.0	20.0	70.0	702046	707204		
DN032/DN010*	35.0	32.0	12.0	10.0	80.0	702047	708519		
DN032/DN010*	35.0	32.0	13.0	10.0	80.0	705999	709035		
DN032/DN015*	35.0	32.0	19.0	16.0	80.0	702048	708520		
DN032/DN020	35.0	32.0	23.0	20.0	80.0	702049	708996		
DN032/DN025	35.0	32.0	29.0	26.0	80.0	702492	708521		
DN040/DN010*	41.0	38.0	12.0	10.0	90.0	704035	708251		
DN040/DN010*	41.0	38.0	13.0	10.0	90.0	706000	710774		
DN040/DN015*	41.0	38.0	19.0	16.0	90.0	702097	708252		
DN040/DN020	41.0	38.0	23.0	20.0	90.0	702052	708900		
DN040/DN025	41.0	38.0	29.0	26.0	90.0	702098	708063		
DN040/DN032	41.0	38.0	35.0	32.0	90.0	702099	708005		
DN050/DN010*	53.0	50.0	12.0	10.0	90.0	710754	708522		
DN050/DN010*	53.0	50.0	13.0	10.0	90.0	710755	710775		
DN050/DN015*	53.0	50.0	19.0	16.0	90.0	702100	709087		
DN050/DN020*	53.0	50.0	23.0	20.0	90.0	702056	710776		
DN050/DN025	53.0	50.0	29.0	26.0	90.0	702057	709054		
DN050/DN032	53.0	50.0	35.0	32.0	90.0	702058	709287		
DN050/DN040	53.0	50.0	41.0	38.0	90.0	702059	708019		
DN065/DN015*	70.0	66.0	19.0	16.0	110.0	706699	710777		
DN065/DN020*	70.0	66.0	23.0	20.0	110.0	702060	710778		



3.2 STERI-Red® E DIN 11865-RE

zusätzliche Oberflächenqualitäten analog Seite | additional surface qualities analog page 85

DIN	A	B	A1	B1	C	MB 1.4435	e-pol. 1.4435		
DN065/DN025*	70.0	66.0	29.0	26.0	110.0	702061	707203		
DN065/DN032*	70.0	66.0	35.0	32.0	110.0	702062	710779		
DN065/DN040	70.0	66.0	41.0	38.0	110.0	702140	710780		
DN065/DN050	70.0	66.0	53.0	50.0	110.0	702064	707202		
DN080/DN015*	85.0	81.0	19.0	16.0	110.0	710756	710781		
DN080/DN020*	85.0	81.0	23.0	20.0	110.0	710757	710782		
DN080/DN025*	85.0	81.0	29.0	26.0	110.0	702694	710783		
DN080/DN032*	85.0	81.0	35.0	32.0	110.0	702101	710784		
DN080/DN040*	85.0	81.0	41.0	38.0	110.0	702102	710785		
DN080/DN050	85.0	81.0	53.0	50.0	110.0	702103	710786		
DN080/DN065	85.0	81.0	70.0	66.0	110.0	702104	710787		
DN100/DN015*	104.0	100.0	19.0	16.0	135.0	710758	710788		
DN100/DN020*	104.0	100.0	23.0	20.0	135.0	702035	710789		
DN100/DN025*	104.0	100.0	29.0	26.0	135.0	702036	710790		
DN100/DN032*	104.0	100.0	35.0	32.0	135.0	702037	710791		
DN100/DN040*	104.0	100.0	41.0	38.0	135.0	702038	710792		
DN100/DN050*	104.0	100.0	53.0	50.0	135.0	702070	710793		
DN100/DN065	104.0	100.0	70.0	66.0	135.0	702039	710794		
DN100/DN080	104.0	100.0	85.0	81.0	135.0	703565	710795		
DN125/DN080	129.0	125.0	85.0	81.0	150.0	705481	710796		
DN125/DN100	129.0	125.0	104.0	100.0	150.0	710759	710797		
DN150/DN100	154.0	150.0	104.0	100.0	170.0	704620	710798		
DN150/DN125	154.0	150.0	129.0	125.0	170.0	710760	710799		
DN200/DN125	204.0	200.0	129.0	125.0	230.0	710761	710800		
DN200/DN150	204.0	200.0	154.0	150.0	230.0	710762	710801		

*) nicht in der DIN-Norm enthalten | non-standard

ISO	A	B	A1	B1	C	MB 1.4435	e-pol. 1.4435		
DN010/DN008	17.2	14.0	13.5	10.3	60.0	701867	707651		
DN015/DN008	21.3	18.1	13.5	10.3	60.0	701868	707652		
DN015/DN010	21.3	18.1	17.2	14.0	60.0	701951	707653		
DN020/DN008*	26.9	23.7	13.5	10.3	60.0	701871	707654		
DN020/DN010	26.9	23.7	17.2	14.0	60.0	701869	707655		
DN020/DN015	26.9	23.7	21.3	18.1	60.0	701870	707656		
DN025/DN008*	33.7	29.7	13.5	10.3	70.0	701875	707657		
DN025/DN010*	33.7	29.7	17.2	14.0	70.0	701872	707658		
DN025/DN015	33.7	29.7	21.3	18.1	70.0	702491	707659		
DN025/DN020	33.7	29.7	26.9	23.7	70.0	701874	707660		
DN032/DN008*	42.4	38.4	13.5	10.3	80.0	701880	707661		
DN032/DN010*	42.4	38.4	17.2	14.0	80.0	701876	707662		
DN032/DN015*	42.4	38.4	21.3	18.1	80.0	701877	707663		
DN032/DN020	42.4	38.4	26.9	23.7	80.0	701878	707664		
DN032/DN025	42.4	38.4	33.7	29.7	80.0	701879	707665		
DN040/DN008*	48.3	44.3	13.5	10.3	90.0	705030	707666		
DN040/DN010*	48.3	44.3	17.2	14.0	90.0	701881	707667		
DN040/DN015*	48.3	44.3	21.3	18.1	90.0	701882	707668		
DN040/DN020	48.3	44.3	26.9	23.7	90.0	701883	707669		
DN040/DN025	48.3	44.3	33.7	29.7	90.0	703911	707670		
DN040/DN032	48.3	44.3	42.4	38.4	90.0	701885	707671		
DN050/DN015*	60.3	56.3	21.3	18.1	100.0	701886	707673		
DN050/DN020*	60.3	56.3	26.9	23.7	100.0	701887	707674		
DN050/DN025	60.3	56.3	33.7	29.7	100.0	701888	707675		
DN050/DN032	60.3	56.3	42.4	38.4	100.0	701889	707676		
DN050/DN040	60.3	56.3	48.3	44.3	100.0	701890	707677		
DN065/DN015*	76.1	72.1	21.3	18.1	110.0	701891	707678		
DN065/DN020*	76.1	72.1	26.9	23.7	110.0	701892	707679		



ISO	A	B	A1	B1	C	MB 1.4435	e-pol. 1.4435		
DN065/DN025*	76.1	72.1	33.7	29.7	110.0	701893	707680		
DN065/DN032*	76.1	72.1	42.4	38.4	110.0	701894	707681		
DN065/DN040	76.1	72.1	48.3	44.3	110.0	701895	707682		
DN065/DN050	76.1	72.1	60.3	56.3	110.0	701896	707683		
DN080/DN015*	88.9	84.3	21.3	18.1	110.0	710802	710806		
DN080/DN020*	88.9	84.3	26.9	23.7	110.0	709433	710807		
DN080/DN025*	88.9	84.3	33.7	29.7	110.0	701897	707684		
DN080/DN032*	88.9	84.3	42.4	38.4	110.0	701898	707685		
DN080/DN040*	88.9	84.3	48.3	44.3	110.0	701899	707686		
DN080/DN050	88.9	84.3	60.3	56.3	110.0	701900	707687		
DN080/DN065	88.9	84.3	76.1	72.1	110.0	701901	707688		
DN100/DN025*	114.3	109.7	33.7	29.7	135.0	701860	707689		
DN100/DN032*	114.3	109.7	42.4	38.4	135.0	701861	707690		
DN100/DN040*	114.3	109.7	48.3	44.3	135.0	701862	707691		
DN100/DN050*	114.3	109.7	60.3	56.3	135.0	701863	707692		
DN100/DN065	114.3	109.7	76.1	72.1	135.0	701864	707693		
DN100/DN080	114.3	109.7	88.9	84.3	135.0	701865	707694		
DN125/DN080	139.7	134.5	88.9	84.3	150.0	710803	710808		
DN125/DN100	139.7	134.5	114.3	109.7	150.0	707259	710809		
DN150/DN100	168.3	163.1	114.3	109.7	170.0	703803	709347		
DN150/DN125	168.3	163.1	139.7	134.5	170.0	703804	710810		
DN200/DN125	219.1	213.9	139.7	134.5	230.0	710804	710811		
DN200/DN150	219.1	213.9	168.3	163.1	230.0	710805	710812		

ASME BPE	A	B	A1	B1	C	MB 1.4435	e-pol. 1.4435		
DN 3/8"/DN 1/4"	9.53	7.75	6.35	4.57	38.0	710813	710818		
DN 1/2"/DN 1/4"	12.7	9.4	6.35	4.57	38.0	710814	710819		
DN 1/2"/DN 3/8"	12.7	9.4	9.53	7.75	38.0	710815	710820		
DN 3/4"/DN 3/8"	19.05	15.75	9.53	7.75	60.0	710816	710821		
DN 3/4"/DN 1/2"	19.05	15.75	12.7	9.4	60.0	702620	710822		
DN 1"/DN 3/8"*	25.4	22.1	9.53	7.75	60.0	710817	710823		
DN 1"/DN 1/2"	25.4	22.1	12.7	9.4	60.0	702622	708003		
DN 1"/DN 3/4"	25.4	22.1	19.05	15.75	60.0	702621	708727		
DN 1 1/2"/DN 1/2"*	38.1	34.8	12.7	9.4	80.0	705638	710824		
DN 1 1/2"/DN 3/4"	38.1	34.8	19.05	15.75	80.0	702624	710825		
DN 1 1/2"/DN 1"	38.1	34.8	25.4	22.1	80.0	702623	708004		
DN 2"/DN 3/4"*	50.8	47.5	19.05	15.75	90.0	702627	710826		
DN 2"/DN 1"	50.8	47.5	25.4	22.1	90.0	702626	709456		
DN 2"/DN 1 1/2"	50.8	47.5	38.1	34.8	90.0	702625	708726		
DN 2 1/2"/DN 1"	63.5	60.2	25.4	22.1	100.0	702630	710827		
DN 2 1/2"/DN 1 1/2"	63.5	60.2	38.1	34.8	100.0	702629	709457		
DN 2 1/2"/DN 2"	63.5	60.2	50.8	47.5	100.0	702628	709458		
DN 3"/DN 1"*	76.2	72.9	25.4	22.1	110.0	702634	710828		
DN 3"/DN 1 1/2"	76.2	72.9	38.1	34.8	110.0	702633	710829		
DN 3"/DN 2"	76.2	72.9	50.8	47.5	110.0	702632	709459		
DN 3"/DN 2 1/2"	76.2	72.9	63.5	60.2	110.0	702631	710830		
DN 4"/DN 2"	101.6	97.38	50.8	34.8	135.0	702637	710831		
DN 4"/DN 2 1/2"	101.6	97.38	63.5	47.5	135.0	702636	710832		
DN 4"/DN 3"	101.6	97.38	76.2	72.9	135.0	702635	709460		
DN 6"/DN 4"	152.4	146.86	101.6	97.38	170.0	709564	710833		

*) nicht in der DIN-Norm enthalten | non-standard

Sonder-Reduzierungen (wie z.B. DIN/ISO, ASME BPE/DIN, etc.)
sind ebenfalls (teilweise aus Vorrat) lieferbar.Special reducers (e.g. DIN/ISO, ASME BPE/DIN, etc.)
are also consignable (partially from stock).



3.3 Red-Stück K

konzentrische Reduzierung, kurze Ausführung

concentric reducer, short type

Legende

B/B1 Innendurchmesser
C Gesamtlänge
D Wandstärke

Abmessungen

DIN 11866-A (DIN 11850)
DIN 11866-B (EN ISO 1127)
ähnlich DIN 11866-C (ASME BPE)

Normative Verweisungen, Anforderungen / Abnahmen (Vormaterial)

DIN 11850
DIN 11852 (nur DIN Abmessungen)
DIN 11866 (teilweise)
EN 10204
EN 10088-1
EN 10217-7
AD 2000-W2 (teilweise)

Kennzeichnung

Hersteller, Werkstoff, Abmessung, Schmelze

Toleranzen (Bezugsnorm)

EN ISO 1127

Verpackung

einzel in Folienbeutel verpackt

Werkstoffe

1.4435 (hergestellt aus HQ-/STERI-Tube®)
1.4404 (hergestellt aus MEDI-Tube®)

weitere Werkstoffe auf Anfrage

Oberflächenbeschaffenheit ("MB")

innen und außen metallblank
Erhöhte Rauheitswerte (> 0.8 µm) möglich!

Key

internal diameter
total length
wall thickness

Dimensions

DIN 11866-A (DIN 11850)
DIN 11866-B (EN ISO 1127)
similar to DIN 11866-C (ASME BPE)

Normative References, Requirements / Approvals (raw material)

DIN 11850
DIN 11852 (only DIN dimensions)
DIN 11866 (partially)
EN 10204
EN 10088-1
EN 10217-7
AD 2000-W2 (partially)

Marking

manufacturer, material, dimension, heat

Tolerances (reference standard)

EN ISO 1127

Packaging

wrapped separately in plastic bag

Materials

316L (made out of HQ-/STERI-Tube® (1.4435) or
MEDI-Tube® (1.4404))

further materials on request

Surface condition ("MB")

inside and outside bright finish
Increased roughness values (> 0.8 µm) possible!



Oberflächenqualitäten | surface qualities

Innenoberfläche internal surface finish	(Zusatz-) Artikel-Nr. (additional) order No
e-polier e-polished	999277
Ra < 0.8 µm (STERI-line®)	999284
Ra < 0.6 µm (STERI-line®)	999279
Ra < 0.5 µm (STERI-line®)	999280
Ra < 0.4 µm (HQ-line®)	999281
Ra < 0.25 µm (HQ-line®)	999283

Bestellbeispiel | ordering example

Artikelbezeichnung + Ausführungen article description + variants	Artikel-Nr. order No
Red-Stück K DN025/015 DIN (1.4435) concentric reducer, short type	703689
e-polier e-polished	+ 999277
Ra < 0.4 µm	+ 999281

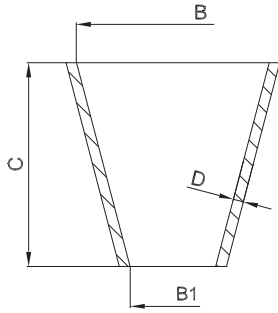

weitere Abmessungen auf Anfrage | further dimensions on request

DIN	B	B1	C	D		MB 1.4435	MB 1.4404		
DN015/DN010	16.0	10.0	11.0	1.5		703685	702112		
DN020/DN010	20.0	10.0	18.0	1.5		703686	702113		
DN020/DN015	20.0	16.0	7.0	1.5		703687	702114		
DN025/DN010*	26.0	10.0	30.0	1.5		703688	702115		
DN025/DN015	26.0	16.0	18.0	1.5		703689	702116		
DN025/DN020	26.0	20.0	11.0	1.5		703690	702117		
DN032/DN015*	32.0	16.0	30.0	1.5		703692	702119		
DN032/DN020	32.0	20.0	22.0	1.5		703693	702120		
DN032/DN025	32.0	26.0	11.0	1.5		703694	702121		
DN040/DN015*	38.0	16.0	41.0	1.5		703695	702122		
DN040/DN020	38.0	20.0	33.0	1.5		703696	702123		
DN040/DN025	38.0	26.0	22.0	1.5		703697	702124		
DN040/DN032	38.0	32.0	11.0	1.5		703698	702125		
DN050/DN020*	50.0	20.0	55.5	1.5		703700	702127		
DN050/DN025	50.0	26.0	44.0	1.5		703701	702128		
DN050/DN032	50.0	32.0	33.0	1.5		703702	702129		
DN050/DN040	50.0	38.0	22.0	1.5		703703	702130		
DN065/DN025*	66.0	26.0	74.5	2.0		703705	702132		
DN065/DN032*	66.0	32.0	63.5	2.0		703706	702133		
DN065/DN040	66.0	38.0	51.0	2.0		703707	702134		
DN065/DN050	66.0	50.0	29.0	2.0		703708	702135		
DN080/DN032*	81.0	32.0	91.5	2.0		703709	702136		
DN080/DN040*	81.0	38.0	80.2	2.0		703710	702137		
DN080/DN050	81.0	50.0	56.0	2.0		703711	702138		
DN080/DN065	81.0	66.0	27.0	2.0		703712	702139		
DN100/DN050*	100.0	50.0	93.0	2.0		703719	702109		
DN100/DN065	100.0	66.0	61.0	2.0		703720	702110		
DN100/DN080	100.0	81.0	34.0	2.0		703721	702111		
DN125/DN080	125.0	81.0	79.0	2.0		710918	710924		
DN125/DN100	125.0	100.0	45.0	2.0		710919	709104		
DN150/DN100	150.0	100.0	90.0	2.0		710920	710925		
DN150/DN125	150.0	125.0	45.0	2.0		710921	710926		
DN200/DN125*	200.0	125.0	140.0	2.0		710922	710927		
DN200/DN150	200.0	150.0	90.0	2.0		710923	710928		

*) nicht in der DIN-Norm enthalten | non-standard



3.3 Red-Stück K

zusätzliche Oberflächenqualitäten analog Seite | additional surface qualities analog page 89

ISO	B	B1	C	D		MB 1.4435	MB 1.4404		
DN010/DN008	14.0	10.3	6.9	1.6		703722	701962		
DN015/DN008	18.1	10.3	14.6	1.6		703724	701963		
DN015/DN010	18.1	14.0	7.7	1.6		703723	701998		
DN020/DN008	23.7	10.3	25.0	1.6		703727	701966		
DN020/DN010	23.7	14.0	18.1	1.6		703725	701964		
DN020/DN015	23.7	18.1	10.4	1.6		703726	701965		
DN025/DN010	29.7	14.0	30.8	1.6		703728	701967		
DN025/DN015	29.7	18.1	23.1	1.6		703729	701968		
DN025/DN020	29.7	23.7	12.7	1.6		703730	701969		
DN032/DN015	38.4	18.1	39.4	1.6		703733	701972		
DN032/DN020	38.4	23.7	28.9	1.6		703734	701973		
DN032/DN025	38.4	29.7	16.2	2.0		703735	701974		
DN040/DN020	44.3	23.7	39.9	2.0		703739	701978		
DN040/DN025	44.3	29.7	27.2	2.0		703740	701979		
DN040/DN032	44.3	38.4	11.0	2.0		703741	701980		
DN050/DN025	56.3	29.7	49.6	2.0		702501	701983		
DN050/DN032	56.3	38.4	33.4	2.0		703745	701984		
DN050/DN040	56.3	44.3	22.4	2.0		703746	701985		
DN065/DN032	72.1	38.4	62.9	2.0		703752	701989		
DN065/DN040	72.1	44.3	51.9	2.0		703753	701990		
DN065/DN050	72.1	56.3	29.5	2.0		703754	701991		
DN080/DN032	84.3	38.4	86.8	2.0		703756	701993		
DN080/DN040	84.3	44.3	75.8	2.0		703757	701947		
DN080/DN050	84.3	56.3	53.4	2.0		703758	701994		
DN080/DN065	84.3	72.1	23.9	2.0		703759	701995		
DN100/DN050	109.7	56.3	100.8	2.0		703763	701959		
DN100/DN065	109.7	72.1	71.3	2.0		703764	701960		
DN100/DN080	109.7	84.3	47.4	2.3		703765	701961		
DN125/DN065	134.5	72.1	118.7	2.3		710929	710933		
DN125/DN080	134.5	84.3	94.8	2.3		709077	710934		
DN125/DN100	134.5	109.7	47.4	2.3		710930	710935		
DN150/DN080	163.1	84.3	148.2	2.3		709177	710936		
DN150/DN100	163.1	109.7	100.8	2.3		710931	710937		
DN150/DN125	163.1	134.5	53.4	2.3		710932	710938		

Zoll / inch**	B	B1	C	D		MB 1.4435	MB 1.4404		
DN ¾"/DN ½"	15.8	9.4	11.0	1.5		705872	710939		
DN 1"/DN ½"	22.1	9.4	23.7	1.5		705871	710940		
DN 1"/DN ¾"	22.1	15.8	11.9	1.5		705727	705738		
DN 1½"/DN 1"	34.8	22.1	23.7	1.5		705728	705739		
DN 2"/DN 1"	47.5	22.1	47.4	1.5		706040	706041		
DN 2"/DN 1½"	47.5	34.8	23.7	1.5		705729	705740		
DN 2½"/DN 1½"	60.2	34.8	47.4	1.5		705730	705741		
DN 2½"/DN 2"	60.2	47.5	23.7	1.5		705731	705742		
DN 3"/DN 1½"	72.9	34.8	71.1	1.5		705732	705743		
DN 3"/DN 2"	72.9	47.5	47.4	1.5		705733	705744		
DN 3"/DN 2½"	72.9	60.2	23.7	2.0		705734	705745		
DN 4"/DN 2"	97.4	47.5	94.8	2.0		705735	705746		
DN 4"/DN 2½"	97.4	60.2	71.1	2.0		705736	705747		
DN 4"/DN 3"	97.4	72.9	47.4	2.0		705737	705748		

***) Abmessungen in Anlehnung an ASME BPE | dimensions following ASME BPE



3.4 Red-Stück E

exzentrische Reduzierung, kurze Ausführung

eccentric reducer, short type

Legende

- B/B1 Innendurchmesser
- C Gesamtlänge
- D Wandstärke

Abmessungen

- DIN 11866-A (DIN 11850)
- DIN 11866-B (EN ISO 1127)
- ähnlich DIN 11866-C (ASME BPE)

Normative Verweisungen, Anforderungen / Abnahmen (Vormaterial)

- DIN 11850
- DIN 11852 (nur DIN Abmessungen)
- DIN 11866 (teilweise)
- EN 10204
- EN 10088-1
- EN 10217-7
- AD 2000-W2 (teilweise)

Kennzeichnung

Hersteller, Werkstoff, Abmessung, Schmelze

Toleranzen (Bezugsnorm)

EN ISO 1127

Verpackung

einzel in Folienbeutel verpackt

Werkstoffe

- 1.4435 (hergestellt aus HQ-/STERI-Tube®)
- 1.4404 (hergestellt aus MEDI-Tube®)

weitere Werkstoffe auf Anfrage

Oberflächenbeschaffenheit ("MB")

innen und außen metallblank
Erhöhte Rauheitswerte (> 0.8 µm) möglich!

Key

- internal diameter
- total length
- wall thickness

Dimensions

- DIN 11866-A (DIN 11850)
- DIN 11866-B (EN ISO 1127)
- similar to DIN 11866-C (ASME BPE)

Normative References, Requirements / Approvals (raw material)

- DIN 11850
- DIN 11852 (only DIN dimensions)
- DIN 11866 (partially)
- EN 10204
- EN 10088-1
- EN 10217-7
- AD 2000-W2 (partially)

Marking

manufacturer, material, dimension, heat

Tolerances (reference standard)

EN ISO 1127

Packaging

wrapped separately in plastic bag

Materials

316L (made out of HQ-/STERI-Tube® (1.4435) or
MEDI-Tube® (1.4404))

further materials on request

Surface condition ("MB")

inside and outside bright finish
Increased roughness values (> 0.8 µm) possible!



Oberflächenqualitäten | surface qualities

Innenoberfläche internal surface finish	(Zusatz-) Artikel-Nr. (additional) order No
e-polier e-polished	999277
Ra < 0.8 µm (STERI-line®)	999284
Ra < 0.6 µm (STERI-line®)	999279
Ra < 0.5 µm (STERI-line®)	999280
Ra < 0.4 µm (HQ-line®)	999281
Ra < 0.25 µm (HQ-line®)	999283

Bestellbeispiel | ordering example

Artikelbezeichnung + Ausführungen article description + variants	Artikel-Nr. order No
Red-Stück E DN025/015 DIN (1.4404) eccentric reducer, short type	702081
e-polier e-polished	+ 999277
Ra < 0.6 µm	+ 999279

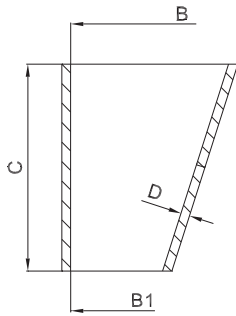

weitere Abmessungen auf Anfrage | further dimensions on request

DIN	B	B1	C	D		MB 1.4435	MB 1.4404		
DN015/DN010	16.0	10.0	16.5	1.5		703606	702077		
DN020/DN010*	20.0	10.0	27.5	1.5		703607	702078		
DN020/DN015	20.0	16.0	11.0	1.5		703608	702079		
DN025/DN010*	26.0	10.0	44.0	1.5		703609	702080		
DN025/DN015	26.0	16.0	27.5	1.5		703610	702081		
DN025/DN020	26.0	20.0	16.5	1.5		703611	702082		
DN032/DN015*	32.0	16.0	44.0	1.5		703613	702084		
DN032/DN020	32.0	20.0	33.0	1.5		703614	702085		
DN032/DN025	32.0	26.0	16.5	1.5		703615	702050		
DN040/DN015*	38.0	16.0	60.4	1.5		703616	702051		
DN040/DN020*	38.0	20.0	49.5	1.5		703617	702086		
DN040/DN025	38.0	26.0	33.0	1.5		703618	702053		
DN040/DN032	38.0	32.0	16.5	1.5		703619	702054		
DN050/DN025*	50.0	26.0	66.0	1.5		703622	702088		
DN050/DN032*	50.0	32.0	49.5	1.5		703623	702089		
DN050/DN040	50.0	38.0	33.0	1.5		703624	702090		
DN065/DN040*	66.0	38.0	77.0	2.0		703628	702063		
DN065/DN050	66.0	50.0	44.0	2.0		703629	702094		
DN080/DN050*	81.0	50.0	85.2	2.0		703632	702067		
DN080/DN065	81.0	66.0	41.2	2.0		703633	702068		
DN100/DN050*	100.0	50.0	137.4	2.0		703638	702075		
DN100/DN065*	100.0	66.0	93.4	2.0		703639	702076		
DN100/DN080	100.0	81.0	52.5	2.0		703640	702040		
DN125/DN080*	125.0	81.0	120.5	2.0		710941	710945		
DN125/DN100	125.0	100.0	68.5	2.0		710942	710946		
DN150/DN100*	150.0	100.0	137.5	2.0		710943	710947		
DN150/DN125	150.0	125.0	68.5	2.0		710944	710948		

*) nicht in der DIN-Norm enthalten | non-standard



3.4 Red-Stück E

zusätzliche Oberflächenqualitäten analog Seite | additional surface qualities analog page 92

ISO	B	B1	C	D		MB 1.4435	MB 1.4404		
DN010/DN008	14.0	10.3	10.2	1.6		703641	701914		
DN015/DN008	18.1	10.3	21.4	1.6		703643	701916		
DN015/DN010	18.1	14.0	11.3	1.6		703642	701996		
DN020/DN008	23.7	10.3	36.8	1.6		703646	701919		
DN020/DN010	23.7	14.0	26.7	1.6		703644	701917		
DN020/DN015	23.7	18.1	15.4	1.6		703645	701918		
DN025/DN010	29.7	14.0	45.3	1.6		703647	701920		
DN025/DN015	29.7	18.1	34.1	1.6		703866	701921		
DN025/DN020	29.7	23.7	18.7	1.6		703648	701922		
DN032/DN015	38.4	18.1	57.4	1.6		703651	701925		
DN032/DN020	38.4	23.7	42.0	1.6		703652	701926		
DN032/DN025	38.4	29.7	23.9	2.0		703653	701927		
DN040/DN020	44.3	23.7	58.8	2.0		703657	701931		
DN040/DN025	44.3	29.7	40.1	2.0		703658	701932		
DN040/DN032	44.3	38.4	16.2	2.0		703659	701933		
DN050/DN032	56.3	38.4	49.2	2.0		703663	701937		
DN050/DN040	56.3	44.3	33.0	2.0		703664	701938		
DN065/DN040	72.1	44.3	76.4	2.0		703670	701943		
DN065/DN050	72.1	56.3	43.4	2.0		703672	701944		
DN080/DN040	84.3	44.3	111.5	2.0		703675	701948		
DN080/DN050	84.3	56.3	78.6	2.0		703676	701997		
DN080/DN065	84.3	72.1	35.2	2.0		703677	701949		
DN100/DN065	109.7	72.1	105.0	2.0		703683	701912		
DN100/DN080	109.7	84.3	69.5	2.3		703684	701913		
DN125/DN100	134.5	109.7	69.8	2.3		710949	710950		

Zoll / inch**	B	B1	C	D		MB 1.4435	MB 1.4404		
DN 1"/DN 1/2"	22.1	9.4	38.1	1.5		705870	706831		
DN 1"/DN 3/4"	22.1	15.8	18.7	1.5		705869	706299		
DN 1 1/2"/DN 1"	34.8	22.1	33.5	1.5		705749	705762		
DN 2"/DN 1"	47.5	22.1	68.4	1.5		705750	705763		
DN 2"/DN 1 1/2"	47.5	34.8	34.9	1.5		705751	705764		
DN 2 1/2"/DN 1"	60.2	22.1	102.3	1.5		705752	705765		
DN 2 1/2"/DN 1 1/2"	60.2	34.8	69.8	1.5		705753	705766		
DN 2 1/2"/DN 2"	60.2	47.5	34.9	1.5		705754	705767		
DN 3"/DN 1"	72.9	22.1	136.9	1.5		705755	705768		
DN 3"/DN 1 1/2"	72.9	34.8	104.4	1.5		705756	705769		
DN 3"/DN 2"	72.9	47.5	69.5	1.5		705757	705770		
DN 3"/DN 2 1/2"	72.9	60.2	34.6	2.0		705758	705771		
DN 4"/DN 2"	97.4	47.5	136.8	2.0		705759	705772		
DN 4"/DN 2 1/2"	97.4	60.2	101.9	2.0		705760	705773		
DN 4"/DN 3"	97.4	72.9	67.3	2.0		705761	705774		

***) Abmessungen in Anlehnung an ASME BPE | dimensions following ASME BPE