



### 3.4 Red-Stück E

exzentrische Reduzierung, kurze Ausführung

eccentric reducer, short type

#### Legende

- B/B1 Innendurchmesser
- C Gesamtlänge
- D Wandstärke

#### Abmessungen

- DIN 11866-A (DIN 11850)
- DIN 11866-B (EN ISO 1127)
- ähnlich DIN 11866-C (ASME BPE)

#### Normative Verweisungen, Anforderungen / Abnahmen (Vormaterial)

- DIN 11850
- DIN 11852 (nur DIN Abmessungen)
- DIN 11866 (teilweise)
- EN 10204
- EN 10088-1
- EN 10217-7
- AD 2000-W2 (teilweise)

#### Kennzeichnung

Hersteller, Werkstoff, Abmessung, Schmelze

#### Toleranzen (Bezugsnorm)

EN ISO 1127

#### Verpackung

einzel in Folienbeutel verpackt

#### Werkstoffe

- 1.4435 (hergestellt aus HQ-/STERI-Tube®)
- 1.4404 (hergestellt aus MEDI-Tube®)

#### weitere Werkstoffe auf Anfrage

#### Oberflächenbeschaffenheit ("MB")

innen und außen metallblank  
Erhöhte Rauheitswerte (> 0.8 µm) möglich!

#### Key

- internal diameter
- total length
- wall thickness

#### Dimensions

- DIN 11866-A (DIN 11850)
- DIN 11866-B (EN ISO 1127)
- similar to DIN 11866-C (ASME BPE)

#### Normative References, Requirements / Approvals (raw material)

- DIN 11850
- DIN 11852 (only DIN dimensions)
- DIN 11866 (partially)
- EN 10204
- EN 10088-1
- EN 10217-7
- AD 2000-W2 (partially)

#### Marking

manufacturer, material, dimension, heat

#### Tolerances (reference standard)

EN ISO 1127

#### Packaging

wrapped separately in plastic bag

#### Materials

316L (made out of HQ-/STERI-Tube® (1.4435) or  
MEDI-Tube® (1.4404))

#### further materials on request

#### Surface condition ("MB")

inside and outside bright finish  
Increased roughness values (> 0.8 µm) possible!



#### Oberflächenqualitäten | surface qualities

Innenoberfläche internal surface finish	(Zusatz-) Artikel-Nr. (additional) order No
e-polier   e-polished	999277
Ra < 0.8 µm (STERI-line®)	999284
Ra < 0.6 µm (STERI-line®)	999279
Ra < 0.5 µm (STERI-line®)	999280
Ra < 0.4 µm (HQ-line®)	999281
Ra < 0.25 µm (HQ-line®)	999283

#### Bestellbeispiel | ordering example

Artikelbezeichnung + Ausführungen article description + variants	Artikel-Nr. order No
Red-Stück E DN025/015 DIN (1.4404) eccentric reducer, short type	702081
e-polier   e-polished	+ 999277
Ra < 0.6 µm	+ 999279

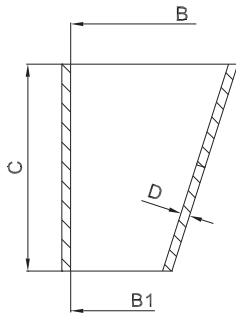

weitere Abmessungen auf Anfrage | further dimensions on request

DIN	B	B1	C	D		MB 1.4435	MB 1.4404		
DN015/DN010	16.0	10.0	16.5	1.5		703606	702077		
DN020/DN010*	20.0	10.0	27.5	1.5		703607	702078		
DN020/DN015	20.0	16.0	11.0	1.5		703608	702079		
DN025/DN010*	26.0	10.0	44.0	1.5		703609	702080		
DN025/DN015	26.0	16.0	27.5	1.5		703610	702081		
DN025/DN020	26.0	20.0	16.5	1.5		703611	702082		
DN032/DN015*	32.0	16.0	44.0	1.5		703613	702084		
DN032/DN020	32.0	20.0	33.0	1.5		703614	702085		
DN032/DN025	32.0	26.0	16.5	1.5		703615	702050		
DN040/DN015*	38.0	16.0	60.4	1.5		703616	702051		
DN040/DN020*	38.0	20.0	49.5	1.5		703617	702086		
DN040/DN025	38.0	26.0	33.0	1.5		703618	702053		
DN040/DN032	38.0	32.0	16.5	1.5		703619	702054		
DN050/DN025*	50.0	26.0	66.0	1.5		703622	702088		
DN050/DN032*	50.0	32.0	49.5	1.5		703623	702089		
DN050/DN040	50.0	38.0	33.0	1.5		703624	702090		
DN065/DN040*	66.0	38.0	77.0	2.0		703628	702063		
DN065/DN050	66.0	50.0	44.0	2.0		703629	702094		
DN080/DN050*	81.0	50.0	85.2	2.0		703632	702067		
DN080/DN065	81.0	66.0	41.2	2.0		703633	702068		
DN100/DN050*	100.0	50.0	137.4	2.0		703638	702075		
DN100/DN065*	100.0	66.0	93.4	2.0		703639	702076		
DN100/DN080	100.0	81.0	52.5	2.0		703640	702040		
DN125/DN080*	125.0	81.0	120.5	2.0		710941	710945		
DN125/DN100	125.0	100.0	68.5	2.0		710942	710946		
DN150/DN100*	150.0	100.0	137.5	2.0		710943	710947		
DN150/DN125	150.0	125.0	68.5	2.0		710944	710948		

\*) nicht in der DIN-Norm enthalten | non-standard



### 3.4 Red-Stück E

zusätzliche Oberflächenqualitäten analog Seite | additional surface qualities analog page 92

ISO	B	B1	C	D		MB 1.4435	MB 1.4404		
DN010/DN008	14.0	10.3	10.2	1.6		703641	701914		
DN015/DN008	18.1	10.3	21.4	1.6		703643	701916		
DN015/DN010	18.1	14.0	11.3	1.6		703642	701996		
DN020/DN008	23.7	10.3	36.8	1.6		703646	701919		
DN020/DN010	23.7	14.0	26.7	1.6		703644	701917		
DN020/DN015	23.7	18.1	15.4	1.6		703645	701918		
DN025/DN010	29.7	14.0	45.3	1.6		703647	701920		
DN025/DN015	29.7	18.1	34.1	1.6		703866	701921		
DN025/DN020	29.7	23.7	18.7	1.6		703648	701922		
DN032/DN015	38.4	18.1	57.4	1.6		703651	701925		
DN032/DN020	38.4	23.7	42.0	1.6		703652	701926		
DN032/DN025	38.4	29.7	23.9	2.0		703653	701927		
DN040/DN020	44.3	23.7	58.8	2.0		703657	701931		
DN040/DN025	44.3	29.7	40.1	2.0		703658	701932		
DN040/DN032	44.3	38.4	16.2	2.0		703659	701933		
DN050/DN032	56.3	38.4	49.2	2.0		703663	701937		
DN050/DN040	56.3	44.3	33.0	2.0		703664	701938		
DN065/DN040	72.1	44.3	76.4	2.0		703670	701943		
DN065/DN050	72.1	56.3	43.4	2.0		703672	701944		
DN080/DN040	84.3	44.3	111.5	2.0		703675	701948		
DN080/DN050	84.3	56.3	78.6	2.0		703676	701997		
DN080/DN065	84.3	72.1	35.2	2.0		703677	701949		
DN100/DN065	109.7	72.1	105.0	2.0		703683	701912		
DN100/DN080	109.7	84.3	69.5	2.3		703684	701913		
DN125/DN100	134.5	109.7	69.8	2.3		710949	710950		

Zoll / inch**	B	B1	C	D		MB 1.4435	MB 1.4404		
DN 1"/DN 1/2"	22.1	9.4	38.1	1.5		705870	706831		
DN 1"/DN 3/4"	22.1	15.8	18.7	1.5		705869	706299		
DN 1 1/2"/DN 1"	34.8	22.1	33.5	1.5		705749	705762		
DN 2"/DN 1"	47.5	22.1	68.4	1.5		705750	705763		
DN 2"/DN 1 1/2"	47.5	34.8	34.9	1.5		705751	705764		
DN 2 1/2"/DN 1"	60.2	22.1	102.3	1.5		705752	705765		
DN 2 1/2"/DN 1 1/2"	60.2	34.8	69.8	1.5		705753	705766		
DN 2 1/2"/DN 2"	60.2	47.5	34.9	1.5		705754	705767		
DN 3"/DN 1"	72.9	22.1	136.9	1.5		705755	705768		
DN 3"/DN 1 1/2"	72.9	34.8	104.4	1.5		705756	705769		
DN 3"/DN 2"	72.9	47.5	69.5	1.5		705757	705770		
DN 3"/DN 2 1/2"	72.9	60.2	34.6	2.0		705758	705771		
DN 4"/DN 2"	97.4	47.5	136.8	2.0		705759	705772		
DN 4"/DN 2 1/2"	97.4	60.2	101.9	2.0		705760	705773		
DN 4"/DN 3"	97.4	72.9	67.3	2.0		705761	705774		

\*\*\*) Abmessungen in Anlehnung an ASME BPE | dimensions following ASME BPE