



5.1 STERI-T® / HQ-T® DIN 11865-T

Steril T-Stück -lang/egal-

aseptic tee -long/equal-

Legende

- A Außendurchmesser
- B Innendurchmesser
- C Gesamtlänge
- C/2 Länge Abgang

Abmessungen

- DIN 11866-A (DIN 11850)
- DIN 11866-B (EN ISO 1127)
- DIN 11866-C (ASME BPE)

Normative Verweisungen, Anforderungen / Abnahmen (Vormaterial)

- DIN 11865
- DIN 11866
- BN2
- EN 10088-1
- EN 10204
- ASTM A269 / A270
- ASME BPE
- ASME SA249/SA249M
- AD 2000-W2

Kennzeichnung

Hersteller, Werkstoff, Abmessung, Schmelze, DIN 11865

Toleranzen (Bezugsnorm)

DIN 11865 / EN ISO 1127

Verpackung









Schweißenden mit Kunststoffkappen verschlossen, einzeln verpackt.

Werkstoffe

1.4435

weitere Werkstoffe auf Anfrage

Oberflächenbeschaffenheit

		MB H2 Ra > 0.8 µm	K400 H3o Ra < 0.8 µm	e-pol. HE3o Ra < 0.5-0.8 µm
innen metallblank				
innen geschliffen				
innen e-polier				
außen metallblank				
außen geschliffen				

Key

- external diameter
- internal diameter
- total length
- length of the branch

Dimensions

- DIN 11866-A (DIN 11850)
- DIN 11866-B (EN ISO 1127)
- DIN 11866-C (ASME BPE)

Normative References, Requirements / Approvals (raw material)

- DIN 11865
- DIN 11866
- BN2
- EN 10088-1
- EN 10204
- ASTM A269 / A270
- ASME BPE
- ASME SA249/SA249M
- AD 2000-W2

Marking

manufacturer, material, dimension, heat, DIN 11865

Tolerances (reference standard)

DIN 11865 / EN ISO 1127

Packaging







Welding ends covered with plastic caps, wrapped separately.

Materials

316L

further materials on request

Surface condition

		K400 H4o Ra < 0.4 µm	e-pol. HE5o Ra < 0.25 µm
inside bright finish			
inside mech. polished			
inside e-polished			
outside bright finish			
outside mech. polished			



Oberflächenqualitäten | surface qualities

Innenoberfläche internal surface finish	(Zusatz-) Artikel-Nr. (additional) order No
Ra < 0.6 µm (STERI-line®)	999279
Ra < 0.5 µm (STERI-line®)	999280
Ra < 0.4 µm (HQ-line®)	999281
Ra < 0.25 µm (HQ-line®)	999283

Bestellbeispiel | ordering example

Artikelbezeichnung + Ausführungen article description + variants	Artikel-Nr. order No
STERI-T® DN025 ISO (1.4435) DIN 11865-T aseptic tee -long/equal-	701227
e-polier e-polished	
Ra < 0.8 µm	

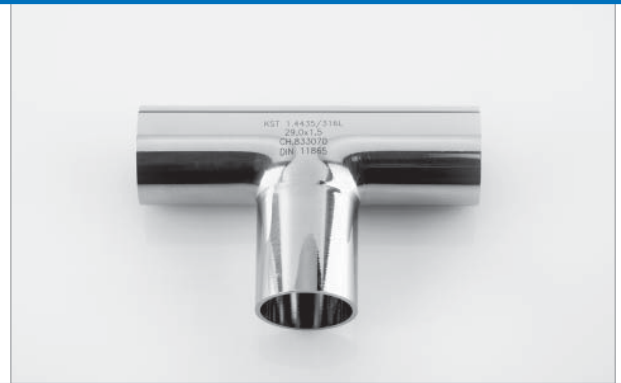
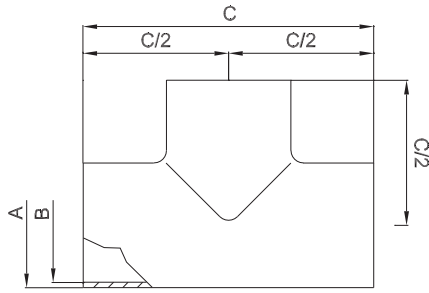

weitere Abmessungen auf Anfrage | further dimensions on request

DIN	Abmessung dimension	A	B	C	C/2	STERI-line®			HQ-line®	
						MB	K400	e-pol.	K400	e-pol.
DN004*	6.0 x 1.0	6.0	4.0	60.0	30.0	703819	711290	711291	711098	711101
DN006	8.0 x 1.0	8.0	6.0	60.0	30.0	700521	701240	701241	711099	711102
DN008	10.0 x 1.0	10.0	8.0	60.0	30.0	705208	705209	705210	711100	711103
DN010*	12.0 x 1.0	12.0	10.0	70.0	35.0	700505	701208	701209	707018	707019
DN010	13.0 x 1.5	13.0	10.0	70.0	35.0	705380	705383	705384	707020	707021
DN015	19.0 x 1.5	19.0	16.0	70.0	35.0	700509	701216	701217	707022	707023
DN020	23.0 x 1.5	23.0	20.0	80.0	40.0	700511	701220	701221	707024	707025
DN025	29.0 x 1.5	29.0	26.0	100.0	50.0	700513	701224	701225	707026	707027
DN032	35.0 x 1.5	35.0	32.0	110.0	55.0	700515	701228	701229	707028	707029
DN040	41.0 x 1.5	41.0	38.0	120.0	60.0	700517	701232	701233	707030	707031
DN050	53.0 x 1.5	53.0	50.0	160.0	80.0	700519	701236	701237	707032	707033
DN065	70.0 x 2.0	70.0	66.0	210.0	105.0	700522	701242	701243	707034	707035
DN080	85.0 x 2.0	85.0	81.0	260.0	130.0	700525	701248	701249	707036	707037
DN100	104.0 x 2.0	104.0	100.0	310.0	155.0	700507	701212	701213	707038	707039
DN125	129.0 x 2.0	129.0	125.0	375.0	187.5	702177	702178	702179	**	**
DN150	154.0 x 2.0	154.0	150.0	450.0	225.0	702189	702190	702191	**	**
DN200	204.0 x 2.0	204.0	200.0	600.0	300.0	711292	711293	711294	**	**

ISO	Abmessung dimension	A	B	C	C/2	STERI-line®			HQ-line®	
						MB	K400	e-pol.	K400	e-pol.
DN008	13.5 x 1.6	13.5	10.3	64.0	32.0	700524	701246	701247	707040	706464
DN010	17.2 x 1.6	17.2	14.0	68.0	34.0	700506	701210	701211	707041	707042
DN015	21.3 x 1.6	21.3	18.1	72.0	36.0	700510	701218	701219	707043	707044
DN020	26.9 x 1.6	26.9	23.7	110.0	55.0	700512	701222	701223	707045	707046
DN025	33.7 x 2.0	33.7	29.7	120.0	60.0	700514	701226	701227	707047	707048
DN032	42.4 x 2.0	42.4	38.4	130.0	65.0	700516	701230	701231	707049	707050
DN040	48.3 x 2.0	48.3	44.3	130.0	65.0	700518	701234	701235	707051	707052
DN050	60.3 x 2.0	60.3	56.3	180.0	90.0	700520	701238	701239	707053	707054
DN065	76.1 x 2.0	76.1	72.1	220.0	110.0	700523	701244	701245	707055	707056
DN080	88.9 x 2.3	88.9	84.3	260.0	130.0	700526	701250	701251	707057	707058
DN100	114.3 x 2.3	114.3	109.7	320.0	160.0	702184	702199	701215	707059	707060
DN125	139.7 x 2.6	139.7	134.5	400.0	200.0	700508	702180	702181	**	**
DN150	168.3 x 2.6	168.3	163.1	500.0	250.0	702192	701214	702193	**	**
DN200	219.1 x 2.6	219.1	213.9	600.0	300.0	**	**	**	**	**

ASME BPE	Abmessung dimension	A	B	C	C/2	STERI-line®			HQ-line®	
						MB	K400	e-pol.	K400	e-pol.
DN ¼"	6.35 x 0.89	6.35	4.57	89.0	44.5	708999	711295	711296	711303	711304
DN ⅜"	9.53 x 0.89	9.53	7.75	89.0	44.5	711297	711298	711299	711305	711306
DN ½"	12.7 x 1.65	12.7	9.4	95.2	47.6	702592	704995	705003	707061	707062
DN ¾"	19.05 x 1.65	19.05	15.75	101.6	50.8	702593	704996	705004	707063	707064
DN 1"	25.4 x 1.65	25.4	22.1	108.0	54.0	702594	704997	705005	707065	707066
DN 1½"	38.1 x 1.65	38.1	34.8	120.6	60.3	702595	704998	705006	707067	707068
DN 2"	50.8 x 1.65	50.8	47.5	146.0	73.0	702596	704999	705007	707069	707070
DN 2½"	63.5 x 1.65	63.5	60.2	158.8	79.4	702597	705000	705008	707071	707072
DN 3"	76.2 x 1.65	76.2	72.9	171.4	85.7	702598	705001	705009	707073	707074
DN 4"	101.6 x 2.11	101.6	97.38	209.6	104.8	704994	705002	705010	707075	707076
DN 6"	152.4 x 2.77	152.4	146.86	285.8	142.9	711300	711301	711302	711307	711308

*) nicht in der DIN-Norm enthalten | non-standard

***) auf Anfrage | on request